

# Relative and absolute pressure transmitter type 680

Pressure range  
0 ... 0.1 – 1000 bar

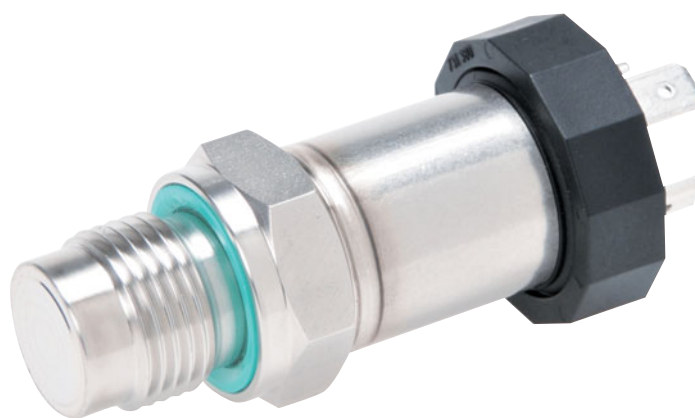

The pressure transmitters of type 680 with piezoresistive measuring elements have compensated, calibrated and amplified sensor signals which are available as standard voltage or current outputs.

The transmitter housing is available with various pressure and electrical connections.

Manufactured from stainless steel, its welded construction provides a watertight seal. With its sophisticated building block system, individual designs to meet specific applications are possible.

- Effective overload protection due to chemically etched chip diaphragm and specially designed glass gland
- Fast and affordable customer specific solutions due to building block system, even for small quantities
- Compact construction with SMD technology enhances operational reliability in the presence of shock and vibration
- Welded construction provides 100% sealing against media

<b>Technical overview</b>			
<b>Pressure type <sup>1)</sup></b>			
Relative and absolute	0 ... 25 bar		
Overpressure	> 25 ... 1000 bar		
<b>Overload</b>			
At Pressure ranges 0.1 ... 2 bar	3x pressure range, min. 3 bar		
At Pressure ranges > 2 ... 600 bar	3x pressure range, max. 850 bar		
At Pressure ranges > 600 ... 1000 bar	1500 bar		
<b>Rupture pressure</b>			
At Pressure ranges 0.1 ... 2 bar	> 200 bar		
At Pressure ranges > 2 ... 600 bar	> 850 bar		
At Pressure ranges > 600 ... 1000 bar	> 1500 bar		
<b>Medium</b>			
Permissible medium	liquids and gases		
<b>Material</b>			
Pressure connection, diaphragm, case	stainless steel 1.4435 (316L) (Titanium or Hastelloy C on request)		
Sealing material	FPM (other on request)		
<b>Temperature <sup>2)</sup></b>			
Medium temperature	-40 ... +150 °C		
Ambient temperature	-40 ... +125 °C		
Storage temperature	-40 ... +125 °C		
<b>Output and power supply <sup>3)4)</sup></b>			
	<b>output</b>	<b>power supply</b>	<b>permissible load <sup>5)</sup></b>
3-wire	0 ... 5 V 0 ... 10 V	12 ... 30 VDC 12 ... 30 VDC	> 10 kOhm > 10 kOhm
2-wire	4 ... 20 mA	9 ... 33 VDC	$\frac{\text{supply voltage} - 9V}{0.02 A}$ [Ohm] max.
2-wire (Ex)	4 ... 20 mA	9 ... 28 VDC	$\frac{\text{supply voltage} - 9V}{0.02 A}$ [Ohm] max.
<b>Ex-Version</b>		<b>gas</b>	<b>dust</b>
Ex-Admission (Depending on execution, see valid ATEX certificate)		II 1G Ex ia IIB/IIC T3 ... T6	II 1D Ex iaD 20 IP6x T145 ... T70 °C
Standards		EN 60079-0 / EN 60079-11	EN 61241-0 / EN 61241-11
<b>Temperature class Ex-Version</b>		<b>T6</b>	<b>T4</b>
Ambient temperature Ta	-40 ... +50 °C	-40 ... +85 °C	-40 ... +125 °C
Medium temperature	-40 ... +50 °C	-40 ... +110 °C	-40 ... +150 °C
<b>Electrical connection</b>			
Cable	PUR, PE or Teflon in variable lengths <sup>6)</sup>		
Connector <sup>7)</sup>	DIN EN 175301-803-A / Lumberg RSF 4 / RSF 50 / Binder 723		
<b>Pressure connection</b>			
Inside thread	G ¼ <sup>1)</sup>		
Outside thread	G ¼, G ½ <sup>1)</sup>		
<b>Tests / Admissions</b>			
	<b>norm</b>	<b>character</b>	<b>level</b>
Mechanical load	EN 60068-2-6 EN 60068-2-27	vibration shock	10 g (4 ... 2000 Hz, oscillation ± 10 mmp) 100 g (pulse duration 6 ms)
Interference emit	EN 55022 EN 61000-4-2 EN 61000-4-3	emitted interference, class B discharge static electricity electromagnetic radiation	< 30 dBµV/m (0.03 ... 1 GHz) 8 kV contact-, 15 kV air discharge 10 V/m, 0.08 ... 2.7 GHz, 80% AM 1 kHz, 3s
Interference resistance	EN 61000-4-4 EN 61000-4-5 EN 61000-4-6	fast transients (burst) impulse voltage (surge) grid-bound electromagnetic blockage	4 kV Line-Line 0.5 kV/42 Ohm, Line-Earth 1 kV/42 Ohm 10 V, 0.15 ... 80 MHz, 80% AM 1 kHz, 3s
<b>Packaging</b>			
Single packaging	carton padded cellular material		
<b>Weight</b>			
Cable version (2 m)	~ 250 g		
Connector version	~ 150 g		

**Accuracy**

	total error band <sup>(1)</sup> [±%fs] per pressure ranges [bar]				
	0.1 ... 0.5	> 0.5 ... 2	> 2 ... 100	> 100 ... 600	> 600 ... 1000
Characteristic line deviation [±%FS] 0.25 or 0.1 (typ./ max.) 0 ... +70 °C	1.0 / 1.5	0.7 / 1.0	0.7 / 1.0	0.7 / 1.0	0.7 / 1.0
(typ./ max.) -25 ... +100 °C	2.0 / 2.5	1.0 / 1.5	1.0 / 1.5	1.0 / 1.5	1.0 / 1.5
Characteristic line deviation [±%FS] 0.05 (typ. / max.) 0 ... +70 °C	-	0.3 / 0.5	0.3 / 0.5	-	-
(typ. / max.) -25 ... +100 °C	-	0.75 / 1.0	0.75 / 1.0	-	-

<sup>(1)</sup> total error band incl. characteristic line deviation, temperature error zero point and operating range, hysteresis and repeatability at max. signal range.

Order code selection table		680. X X X X X X X X X X										
Pressure type	Relative	8										
	Absolute	7										
	Overpressure	6										
Pressure range <sup>1)</sup>	0 ... 100 mbar		0	0								
	0 ... 160 mbar		0	1								
	0 ... 250 mbar		0	2								
	0 ... 400 mbar		0	3								
	0 ... 600 mbar		0	4								
	0 ... 1 bar		0	5								
	0 ... 1.6 bar		0	6								
	0 ... 2.5 bar		0	7								
	0 ... 4 bar		0	8								
	0 ... 6 bar		0	9								
	0 ... 10 bar		1	0								
	0 ... 16 bar		1	1								
	0 ... 25 bar		1	2								
	0 ... 40 bar		6	1	3							
	0 ... 60 bar		6	1	4							
	0 ... 100 bar		6	1	5							
	0 ... 160 bar		6	1	6							
	0 ... 250 bar		6	1	7							
	0 ... 400 bar		6	1	8							
	0 ... 600 bar		6	1	9							
0 ... 1000 bar		6	2	0								
Output / power supply	0 ... 5 V      12 ... 30 VDC							0				
	0 ... 10 V     12 ... 30 VDC							1				
	4 ... 20 mA    9 ... 33 VDC							3				
	4 ... 20 mA    9 ... 28 VDC    intrinsically safe version <sup>2) 3)</sup>							4				
Characteristic line deviation	≤ ± 0.25% fs								1			
	≤ ± 0.10% fs (≤ 600 bar fs)								2			
	≤ ± 0.05% fs (≥ 0.5 bar ... ≤ 100 bar fs)							3,4	3	0,1,2,3		
Temperature range	0 ... + 70 °C compensated, medium temperature permissible: -40 ... +125 °C								0			
	- 25 ... + 100 °C compensated, medium temperature permissible: -40 ... +125 °C								1			
	- 25 ... + 100 °C compensated, medium temperature permissible: -40 ... +150 °C								2			
	- 40 ... + 125 °C compensated, medium temperature permissible: -40 ... +125 °C								3			
	Ex T6 (Ta: -40 ... +50 °C) 0 ... +70 °C compensated (medium temperature permissible: - 40 ... + 50 °C)							4	4			
	Ex T4 (Ta: -40 ... +85 °C) -25 ... +100 °C compensated (medium temperature permissible: - 40 ... + 110 °C)							4	5			
	Ex T3 (Ta: -40 ... +125 °C) -25 ... +100 °C compensated (medium temperature permissible: - 40 ... + 150 °C)							4	6			
Electrical connection	Fig. 1      Binder 723                      5 pin                      IP 67									0		
	Fig. 2      DIN EN 175301-803-A									1		
	Fig. 3      Lumberg                                      4 pin RSF 4                      IP 20									2		
	Fig. 4      Lumberg                                      5 pin RSF 50                      IP 68		6,7							3		
	Fig. 5      PUR    IP 67									4		
	Fig. 6      PUR with kink guard                      IP 67									5		
	Fig. 5      Teflon    IP 67									9		
Pressure connection	Inside thread	Fig. 10      G ¼								0	0	
		Fig. 11      G ¼								0	1	
		Fig. 12      G ¼ manometer DIN 16288								0	2	
	Outside thread	Fig. 13      G ½									0	3
		Fig. 14      G ½ diaphragm at front									0	4
		Fig. 15      G ½ diaphragm flush with front									0	5
		Fig. 16      G ½ manometer DIN 16288									0	6
Version											N	

<sup>1)</sup> Other pressure ranges on request

<sup>2)</sup> II 1G Ex ia IIB/IIC T3...T6 / II 1D Ex iaD 20 IP6x T145...T70°C (Depending on execution, see valid ATEX certificate)

<sup>3)</sup> Indicate correct medium

Fig. 10

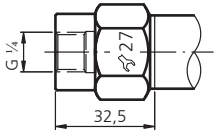

Fig. 11

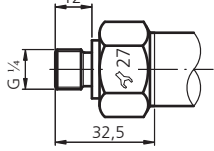

Fig. 12

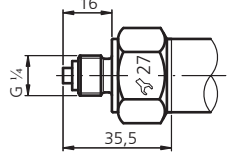

Fig. 13

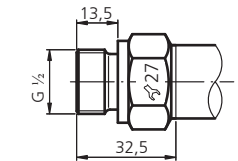

Fig. 14

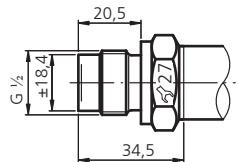

Fig. 15

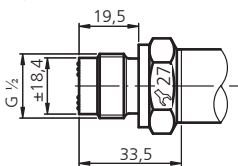
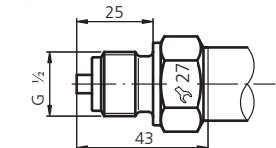
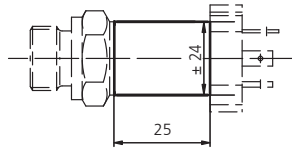

Fig. 16



Version for medium temperature up to +125 °C



Version for medium temperature > +125 ... max. +150 °C

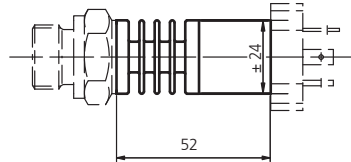

Fig. 1

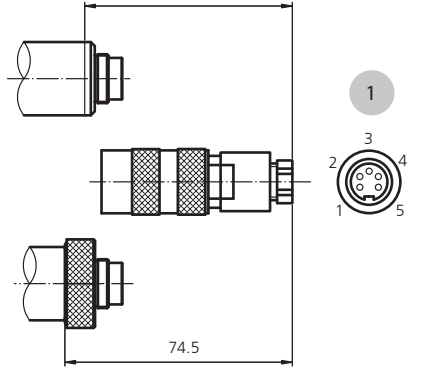

Fig. 2

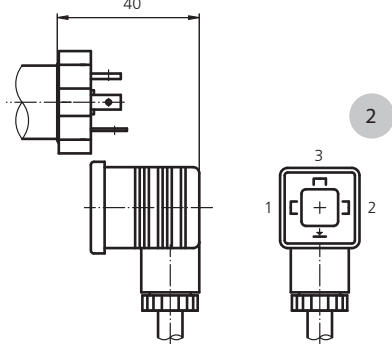

Fig. 3

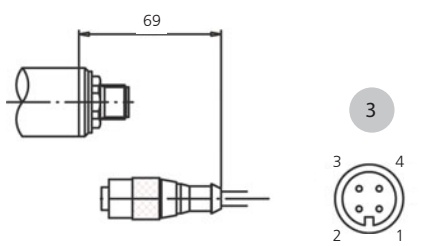

Fig. 4

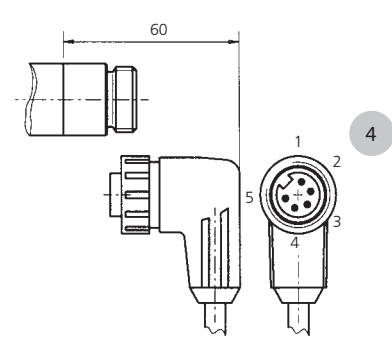

Fig. 5

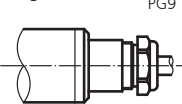
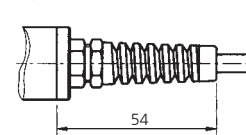

Fig. 6



	Pin / Colour	2-wire	3-wire
1	1	OUT	OUT
	3	IN	IN
	4		GND
2	1	IN	IN
	2	OUT	OUT
	3		GND
3	1		GND
	3	OUT	OUT
	4	IN	IN
4	1	OUT	OUT
	3	IN	IN
	4		GND
5	white	IN	IN
	yellow	OUT	GND
	brown		OUT



FOR FINE PRESSURE AND FLOW MEASUREMENT

Huba Control AG  
Headquarters

Industriestrasse 17  
5436 Würenlos  
Telefon +41 (0) 56 436 82 00  
Telefax +41 (0) 56 436 82 82  
info.ch@hubacontrol.com

Huba Control AG  
Niederlassung Deutschland

Schlattgrabenstrasse 24  
72141 Walddorfhäslach  
Telefon +49 (0) 7127 23 93 00  
Telefax +49 (0) 7127 23 93 20  
info.de@hubacontrol.com

Huba Control SA  
Succursale France

Rue Lavoisier  
Technopôle Forbach-Sud  
57602 Forbach Cedex  
Téléphone +33 (0) 387 847 300  
Télécopieur +33 (0) 387 847 301  
info.fr@hubacontrol.com

Huba Control AG  
Vestiging Nederland

Hamseweg 20A  
3828 AD Hoogland  
Telefoon +31 (0) 33 433 03 66  
Telefax +31 (0) 33 433 03 77  
info.nl@hubacontrol.com

Huba Control AG  
Branch Office United Kingdom

Unit 13 Berkshire House  
County Park Business Centre  
Shrivenham Road  
Swindon - Wiltshire SN1 2NR  
Phone +44 (0) 1993 776667  
Fax +44 (0) 1993 776671  
info.uk@hubacontrol.com

[www.hubacontrol.com](http://www.hubacontrol.com)