

Mates To Virtually Any Encoder
 Ranges: 0-50 to 0-250 inches
 Available With or Without Encoder

PT5600

Specification Summary:

GENERAL
 Full Stroke Range Options 0-50 to 0-250 inches
 Motion Conversion Ratio 8 inches per turn, *see ordering information*
 Accuracy the lesser of 0.02% full stroke or 0.04% of measurement range
 Measuring Cable Options stainless steel or thermoplastic
 Module Material hard anodized aluminum
 Maximum Allowable Rotational Sensor Torque 1.0 in.-lbs.
 Weight 5 lbs. max.

ENVIRONMENTAL
 Operating Temperature -40° to 200°F (-40° to 90°C)

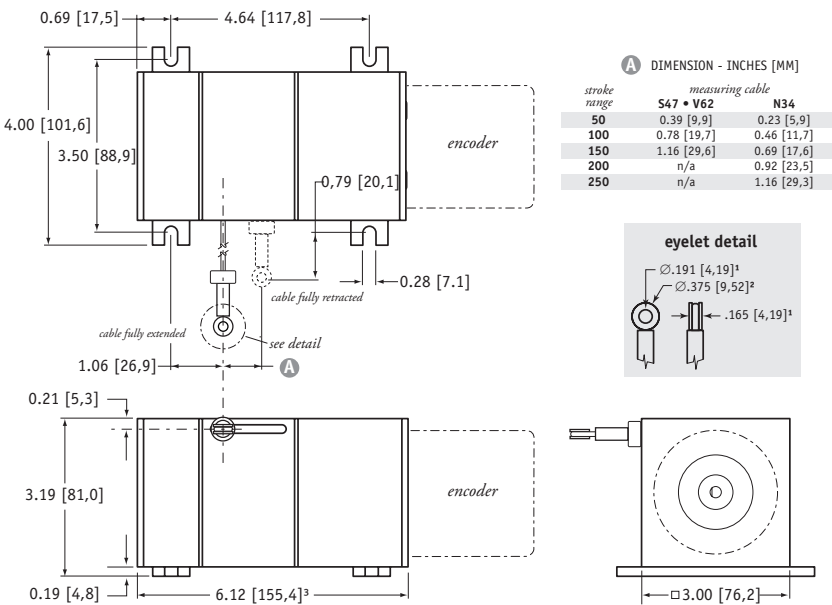

stroke range	measuring cable	
	S47 • V62	N34
50	0.39 [9,9]	0.23 [5,9]
100	0.78 [19,7]	0.46 [11,7]
150	1.16 [29,6]	0.69 [17,6]
200	n/a	0.92 [23,5]
250	n/a	1.16 [29,3]

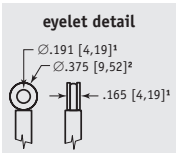

DIMENSIONS ARE IN INCHES [MM]
 tolerances are 0.03 IN. [0.5 MM] unless otherwise noted.
¹ tolerance = +.005 - .001 [+13 - .03]
² tolerance = +.005 - .005 [+13 - .13]
³Overall dimension may vary depending on encoder configuration.

Ordering Information:

Model Number:

PT5600 - _____ - _____ - _____ - _____
 order code: **R** **A** **B** **C**

Sample Model Number:

PT5600 - 100 - N34 - FR - F01

- R** range: 100 inches
- A** measuring cable: .034 nylon-coated stainless
- B** cable exit: front
- C** rotational sensor mounting style: F01 (2.5-in. sq. flange)

» Trying to reorder but can't find your existing model number? Please contact factory for help.

Full Stroke Range:

R order code:	50	100	150	200	250
full stroke range, min:	50 in.	100 in.	150 in.	200 in.	250 in.
cable tension (±20%):	41 ounces	41 ounces	41 ounces	21 ounces	21 ounces

Measuring Cable:

order code:	N34	S47	V62
measuring cable:	.034 nylon-coated stainless steel	.047 stainless steel	.062 thermoplastic
available stroke ranges:	<i>all ranges</i>	<i>all ranges up to 150 inches</i>	<i>all ranges up to 150 inches</i>
conversion ratio:	1 turn = 8.002 ± 0.022 inches	1 turn = 8.042 ± 0.022 inches	1 turn = 8.077 ± 0.022 inches

Cable Exit:

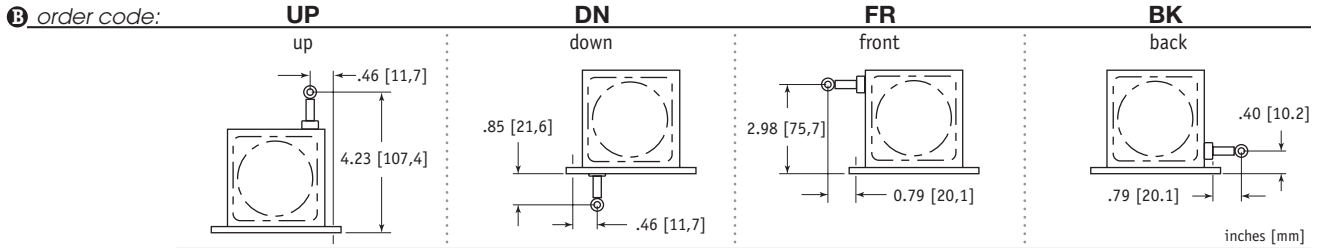

Rotational Sensor Mounting Style:

order code:	F01	F02	S01	S02	S04
	2.5-in. Flange Mount 3/8-inch shaft	2-in. Flange Mount 3/8-inch shaft	Face-Mount 6 mm shaft M4 mounting screws	Face-Mount 10 mm shaft M4 mounting screws	Face-Mount 10 mm shaft M3 mounting screws

Note: If you don't see your encoder style, please contact factory. All encoder types supported.

F01 - 2½-inch Sq. Flange Mount (3/8-inch shaft)

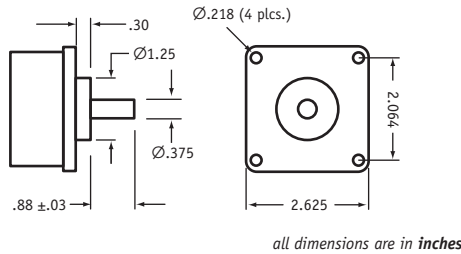

F02 - 2-inch Sq. Flange Mount (3/8-inch shaft)

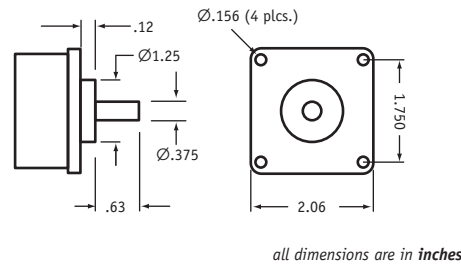

S01 - Face-Mount (6mm shaft/M4 screws)

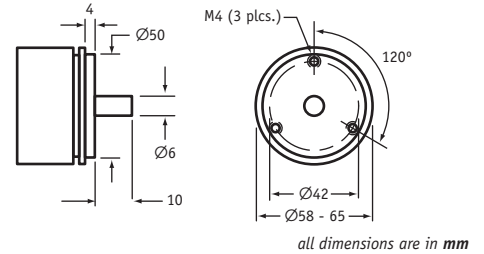

S02 - Face-Mount (10mm shaft/M4 screws)

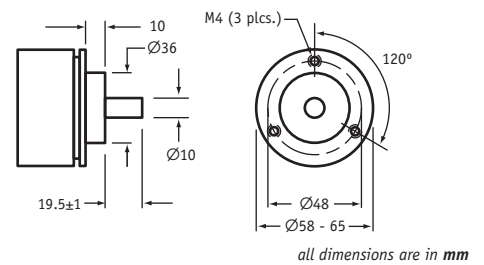

S04 - Face-Mount (10mm shaft/M3 screws)

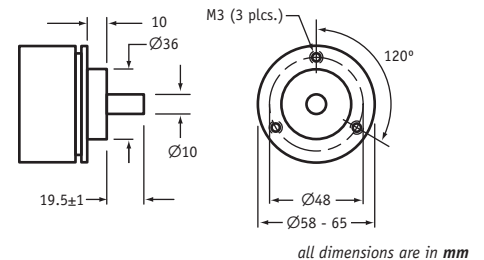

version: 4.2 last updated: September 16, 2008