

10164

VHO LOW CAPACITY FORCE SENSOR

The VHO stands for "Very High Overload" protection in all ranges. Model 10164 incorporates a bidirectional overload protection system. At approximately 130% of the full scale capacity of the load cell, pre-loaded springs are engaged which direct the force path away from the sensing structure and through the housing. This protects it from damage due to loads up to 1000 lbs. VHO load cells can be mounted in series providing a dual range force measurement package. For example, a 5 lb. capacity unit can be mounted in series with the 100 lb. version. This package allows high measurement resolution in the 0 to 5 lbs. range. At approximately 6.5 lbs., the overload system engages for the 5 lb. load cell. The force path is then transferred around the 5 lb. load cell and measured by the 100 lb. sensing structure. At 130 lbs., the overload stops are engaged for the 100 lb. unit, and the entire assembly is protected from overload up to 1000 lbs.

MODEL	CAPACITY
	LBS
10164-050	5
10164-011	10
10164-021	20
10164-051	50
10164-012	100



SPECIFICATIONS

Capacities..... 5 to 100 lbs. (See chart)
 Overload protection up to 1,000 lb.
 without damaging load cells
 Output at F.S., nominal..... 2.0 mV/V
 Non-linearity..... 0.10% of F.S.
 Hysteresis..... 0.10% of F.S.
 Zero balance..... 1% of F.S.
 Compensated temperature..... 70 to 170°F
 Useable temperature..... -65 to +250°F
 Temperature effect on zero..... 0.002% of F.S./°F
 Temperature effect on span..... 0.002% of Rdg./°F
 Bridge resistance..... 350 Ohms
 Excitation voltage, maximum..... 20 Vdc
 Material Aluminum

DIMENSIONS

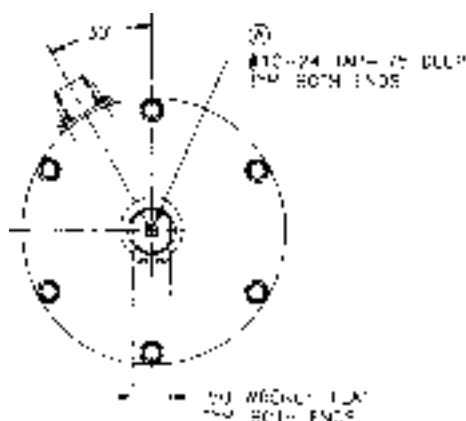

2012C-85-411 CONNECTOR
 WELDING CONNECTOR SUPPLIED

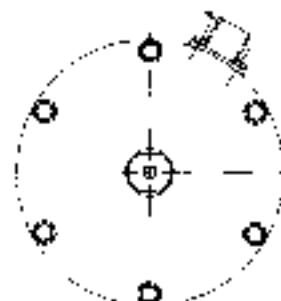

DWG

TFNS ON UPSIDE